

ENVIRONMENTAL REVIEW
FOR THE
KY RT 80/KY RT 476 Interconnection
Project
BY
Perry County Fiscal Court

PREPARED BY
KENTUCKY RIVER AREA DEVELOPMENT DISTRICT
ON BEHALF OF THE
PERRY COUNTY FISCAL COURT

TABLE OF CONTENTS

ENVIRONMENTAL ASSESSMENT DETERMINATIONS AND COMPLIANCE FINDINGS FOR HUD –ASSISTED PROJECTS 24 CFR PART 58

PROJECT INFORMATION	1
DESCRIPTION OF PROPOSED PROJECT	2
FUNDING INFORMATION	3
ESTIMATED TOTAL HUD FUNDED AMOUNT	3
ESTIMATED TOTAL PROJECT COST	3
COMPLIANCE WITH 24 CFR 50.4, 58.5, AND 58.6 LAWS AND AUTHORITIES	3
ENVIRONMENTAL ASSESSMENT FACTORS	7
ADDITIONAL STUDIES PERFORMED	9
FIELD INSPECTION	9
LIST OF SOURCES, AGENCIES AND PERSON CONSULTED	10
LIST OF PERMITS OBTAINED	10
PUBLIC OUTREACH	10
CUMULATIVE IMPACT ANALYSIS	10
ALTERNATIVES	11
SUMMARY OF FINDINGS AND CONCLUSIONS	11
MITIGATIONS MEASURES AND CONDITIONS	11
DETERMINATION	12
ENVIRONMENTAL REVIEW STATUS	13
DLG ENVIRONMENTAL SUBMITTAL CHECKLIST	14, 15
ENVIRONMENTAL REVIEW RECORD CHECKLIST	16

EXHIBITS

1. CLEARING HOUSE COMMENTS	17
2. STATE HISTORIC PRESERVATION OFFICER CORRESPONDENCE AND	23
3. FLOODPLAIN AND WETLANDS MAPS/DATA	70
4. NATURAL RESOURCE CONSERVATION SERVICE CORRESPONDENCE	85
5. U.S. FISH AND WILDLIFE SERVICE CORRESPONDENCE	89
6. KENTUCKY FISH AND WILDLIFE CORRESPONDENCE	96
7. WILD AND SCENIC RIVERS DATA	100
8. AIR QUALITY DATA	104
9. DIVISION OF WATER CORRESPONDENCE	112
10. SITE CONTAMINATION DATA	122
11. SOLE SOURCE AQUIFER DATA	124
12. DIVISION OF WASTE MANAGEMENT CORRESPONDENCE	126
13. FEMA CORRESPONDENCE	133
14. HUD CORRESPONDENCE	136
15. TRIBAL HISTORIC PRESERVATION OFFICE	137
16. US ARMY CORPS OF ENGINEERS	140
17. PROJECT MAPS	144
18. COMBINED NOTICE TO PUBLIC OF NO SIGNIFICANT IMPACT AND NOTICE TO PUBLIC OF REQUEST FOR RELEASE OF FUNDS AND TEAR SHEET	152



U.S. Department of Housing and Urban Development

1200 M Street, SW Washington, DC 20410 www.hud.gov

espanol.hud.gov

**Environmental Assessment
Determinations and Compliance Findings for HUD-assisted Projects
24 CFR Part 58**

Project Information

Project Name: KY RT 80/KY RT 476 Interconnection Project

Responsible Entity: Perry County Fiscal Court

Grant Recipient (if different than Responsible Entity):

State/Local Identifier: KY201909071177/19A-040

Preparer: Angelia Hall, Kentucky River Area Development District

Certifying Officer Name and Title: Scott Alexander, Judge Executive

Grant Recipient (if different than Responsible Entity): N/A

Consultant (if applicable): N/A

Direct Comments to:

Angelia Hall

KY River Area Development District

941 N. Main St.

Hazard KY 41701

angelia@kradd.org

Project Location: Route 80/476, Perry County, KY 41701/Knott County, KY 41822 – GPS Coordinates; (North Pump Station) – Longitude -83°6'26.301"W, Latitude 37°22'4.21"N; (Water Storage Tank) – Longitude -83°6'49.7541"W, Latitude 37°21'22.931"N; (Master Meter) – Longitude -83°6'48.81"W, Longitude 37°21'22.227"N; (South Pump Station) – Longitude -83°8'33.444"W, Latitude 37°20'35.981"N.

KY HWY 550, Perry County, KY 41701 – GPS Coordinates; (Meter) – Longitude -83°6'57.35"W, Latitude 37°20'34.948"N

KY HWY 1087, Perry County, KY 41701 – GPS Coordinates; (Meter) – Longitude -83°7'7.529"W, Latitude 37°22'24.387"N

Montgomery Creek, HWY 1102, Knott County, KY 41822 – GPS Coordinates; (Pump Station) – Longitude -83°2'19.632"W, Latitude 37°21'11.832"N

Irishman Creek, HWY 1231, Knott County, KY 41822– GPS Coordinates; (Pump Station) – Longitude -82°59'49.8"W, Latitude 37°16'30.439"N

Description of the Proposed Project [24 CFR 50.12 & 58.32; 40 CFR 1508.25]:

The Perry County Fiscal Court is working to interconnect the systems of Knott County Water and Sewer District and the City of Hazard. Recently with cold weather the City of Hazard has experienced issues with supplying water to the Village of Buckhorn. This project should assist in alleviating some of these issues in the future. It will also assist in alleviating issues to Hazard: Appalachian Regional Health and the Industrial Park should they arise.

The project proposes to upgrade the Knott County Water and Sewer District (KCWSD) distribution system at its terminus at the Knott/Perry county line on KY 80. Upgrades will include modifying and upgrading 2 existing booster pump stations (BPS). The Irishman Creek BPS will require a minimum upgrade of pumps and VFD controls to increase the current flow capacity as well as the in-series Montgomery Creek BPS will require matching upgrade capacity. A new BPS will be required along RT 80 to pump to a new ground storage tank which be constructed near the Knott/Perry County. The tank will gravity flow thru approximately 6,000 linear feet (LF) of 8" SDR-17 PVC transmission line and tie into the Perry County system near the intersection of RT 80 and RT 476. Master meter and isolation valves with SCADA control will be installed along the 8" interconnect for wholesale service from KCWSD to the City of Hazard. There will also be two additional interconnections between the KCWSD and the City of Hazard. The first will be at Ball Fork and will extend approximately 400 LF of 6" PVC transmission line and the second will be at West Highway 550 and will extend approximately 2,100 LF 6" PVC transmission line and provide SCADA controls and master meters. With these upgrades KCWSD can supply up to 500,000 Gal/Day of additional water to Perry County.

Statement of Purpose and Need for the Proposal [40 CFR 1508.9(b)]:

This project will assist in providing a back-up water source to the City of Hazard and Perry County so that it will be able to provide water to residents of the Village of Buckhorn and to assist with providing extra pressure to other areas of the system, the east central and Northern sections of Perry County, during emergency water shortages, power outages, repairs to the City water system, and as a backup water supply to allow Hazard to better serve their residents, the Appalachian Regional Healthcare, Hazard Hospital complex and UK Center for Excellence in Rural Health Center.

Existing Conditions and Trends [24 CFR 58.40(a)]:

The City of Hazard water system serves 85% of the households in Perry County with potable water as well as a majority of the businesses and commercial customers. Several sections of the Hazard system are aged 50 plus years old and are experiencing severe problems especially in very cold winter weather. The system has encountered excessive water outages for prolonged periods of time resulting in some customers being without water for weeks at a time.

Funding Information

Grant Number	HUD Program	Funding Amount
ARC 19A-040	ARC	\$500,000
	AML Pilot	\$1,200,000

Estimated Total HUD Funded Amount: \$500,000

Estimated Total Project Cost (HUD and non-HUD funds) [24 CFR 58.32(d)]: \$1,700,000

Compliance with 24 CFR 50.4, 58.5, and 58.6 Laws and Authorities

Record below the compliance or conformance determinations for each statute, executive order, or regulation. Provide credible, traceable, and supportive source documentation for each authority. Where applicable, complete the necessary reviews or consultations and obtain or note applicable permits of approvals. Clearly note citations, dates/names/titles of contacts, and page references. Attach additional documentation as appropriate.

Compliance Factors: Statutes, Executive Orders, and Regulations listed at 24 CFR §58.5 and §58.6	Are formal compliance steps or mitigation required?	Compliance determinations
STATUTES, EXECUTIVE ORDERS, AND REGULATIONS LISTED AT 24 CFR 50.4 & 58.6		

Airport Hazards 24 CFR Part 51 Subpart D	Yes No <input type="checkbox"/> <input checked="" type="checkbox"/>	No impact. There are no airports on or within 2,500 feet of the proposed project area.
Coastal Barrier Resources Coastal Barrier Resources Act, as amended by the Coastal Barrier Improvement Act of 1990 [16 USC 3501]	Yes No <input type="checkbox"/> <input checked="" type="checkbox"/>	<i>No Impact. Hazard, Perry County, Kentucky has no Coastal areas.</i>
Flood Insurance Flood Disaster Protection Act of 1973 and National Flood Insurance Reform Act of 1994 [42 USC 4001-4128 and 42 USC 5154a]	Yes No <input type="checkbox"/> <input checked="" type="checkbox"/>	The Perry County Fiscal Court has completed the eight step process per the required 24 CFR 55 since sections of the water project appear to be located within the bounds of the 100-year floodplain. The Perry County Fiscal Court participates in the National Flood Insurance Program. The Floodplains and Wetlands Early Public Notice was ran in the May 21, 2020 edition of The Hazard Herald. The Floodplain and the Wetland Notice of Explanation was run in the June 11, 2020 edition of The Hazard Herald. No public comments were received.

STATUTES, EXECUTIVE ORDERS, AND REGULATIONS LISTED AT 24 CFR 50.4 & 58.5

Clean Air Clean Air Act, as amended, particularly section 176(c) & (d); 40 CFR Parts 6, 51, 93	Yes No <input type="checkbox"/> <input checked="" type="checkbox"/>	No impact. Project was submitted to the Division for Air Quality on 5/22/2020. Per the response received on 6/23/2020. "The Division would like to offer the following suggestions on how this project can help us stay in compliance with the NAAQS. These air quality control strategies are beneficial to the health of citizens of Kentucky. Utilize alternatively fueled equipment, Utilize other emission controls that are applicable to utilized equipment, and reduce idling time on equipment."
Coastal Zone Management Coastal Zone Management Act, sections 307(c) & (d)	Yes No <input type="checkbox"/> <input checked="" type="checkbox"/>	<i>No Impact. There are no coastal areas within Hazard, Perry County, Kentucky.</i>
Contamination and Toxic Substances 24 CFR Part 50.3(i) & 58.5(i)(2)	Yes No <input type="checkbox"/> <input checked="" type="checkbox"/>	No impact. The US EPA web site database was searched in order to identify any listed contamination areas, none were noted.
Endangered Species	Yes No	No Impact. Per response from Jennifer Garland

<p>Endangered Species Act of 1973, particularly section 7; 50 CFR Part 402</p>	<p><input type="checkbox"/> <input checked="" type="checkbox"/></p>	<p>dated May 12, 2020, the US Fish and Wildlife states, "Significant impacts to federally-listed species are not likely to result from this project as currently proposed. Project re-coordination is needed if the project changes or if new species or critical habitats are listed that could be impacted by the project."</p> <p>Per letter dated 3/13/2020, the KY Fish and Wildlife responded the Grey bat, Indiana Bat, Northern Long-eared bat and Kentucky Arrow Darter are known to occur within the project area and recommenced contacting the US Fish & Wildlife Services.</p> <p>There will be a quarter acre of tree clearing will be required of the project. Any recommendations to minimize impacts will be followed.</p>
<p>Explosive and Flammable Hazards</p> <p>24 CFR Part 51 Subpart C</p>	<p>Yes No <input type="checkbox"/> <input checked="" type="checkbox"/></p>	<p>No impact. There will be no above ground storage tanks with explosive and/or flammable materials on or near the project.</p>
<p>Farmlands Protection</p> <p>Farmland Protection Policy Act of 1981, particularly sections 1504(b) and 1541; 7 CFR Part 658</p>	<p>Yes No <input type="checkbox"/> <input checked="" type="checkbox"/></p>	<p>No impact. Per letter dated 2/28/2020, Perri Pedley, Soil Scientist, NRCS, "Based on the information contained in your request and accompanying maps, no conversion of agricultural lands will occur or be negatively impacted by the proposed undertaking. This office has no additional concerns at this time."</p>
<p>Floodplain Management</p> <p>Executive Order 11988, particularly section 2(a); 24 CFR Part 55</p>	<p>Yes No <input checked="" type="checkbox"/> <input type="checkbox"/></p>	<p><i>The project was submitted to the DOW on February 5, 2020 and USACOE on February 21, 2020.</i></p> <p><i>In a response dated May 11, 2020 the USACOE stated:</i></p> <p><i>"[I]f any stream crossings are required, the crossing would be constructed utilizing directional bore methodology. Please note that streams and adjacent wetlands are considered waters of the United States pursuant to Section 404 of the Clean Water Act (CWA).</i></p> <p><i>We encourage a construction plan that will avoid wetland and/or stream impacts if possible. If wetland or stream impacts are unavoidable, a DA permit application should be submitted to this office before any work is done. Based on the information included in your submittal and the</i></p>

		<p><i>review of available maps, it does NOT appear that a DA permit would be required for this proposal.”</i></p> <p><i>Per comments received on March 9, 2020 the DOW Division of Floodplain Management stated:</i></p> <p><i>“For pipeline stream crossings that are not covered under 401 KAR 4:050, a Kentucky DOW Application for Permit to Construct Across or Along a Stream must be submitted”</i></p> <p><i>Through review of maps on the US Fish and Wildlife website, there are no wetlands located in the project area.</i></p> <p><i>Through review of FEMA Floodplain maps, the project is located in the 100 year Floodplain. A Floodplains and Wetlands Early Public Notice was published in the Hazard Herald on May 21, 2020. A Floodplain and Wetlands Notice of Explanation in a 100 Year Floodplain was published in the Hazard Herald on June 11, 2020.</i></p> <p><i>No public comments were received.</i></p>
<p>Historic Preservation</p> <p>National Historic Preservation Act of 1966, particularly sections 106 and 110; 36 CFR Part 800</p>	<p>Yes No</p> <p><input type="checkbox"/> <input checked="" type="checkbox"/></p>	<p>No impact. Per letter dated April 17, 2020, Craig A. Potts, Executive Director and State Historic Preservation Officer stated, “Our review indicates that the proposed project will not impact any properties or sites that are listed in or eligible for the National Register of Historic Places. The proposed project should not require an archaeological survey or cultural historic survey.”</p>
<p>Noise Abatement and Control</p> <p>Noise Control Act of 1972, as amended by the Quiet Communities Act of 1978; 24 CFR Part 51 Subpart B</p>	<p>Yes No</p> <p><input type="checkbox"/> <input checked="" type="checkbox"/></p>	<p>No Impact. The project is not located in a high noise area.</p>
<p>Sole Source Aquifers</p> <p>Safe Drinking Water Act of 1974, as amended, particularly section 1424e; 40 CFR Part 149</p>	<p>Yes No</p> <p><input type="checkbox"/> <input checked="" type="checkbox"/></p>	<p>No impact. There are no sole source aquifers identified in the state of Kentucky on the HUD exchange sole source aquifer site.</p>
<p>Wetlands Protection</p> <p>Executive Order 11990, particularly sections 2 and 5</p>	<p>Yes No</p> <p><input type="checkbox"/> <input checked="" type="checkbox"/></p>	<p>No impact. Through review of maps on the US Fish and Wildlife website, there are no wetlands located in the project area.</p>
<p>Wild and Scenic Rivers</p> <p>Wild and Scenic Rivers Act of</p>	<p>Yes No</p>	<p>No impact. There are no wild and scenic rivers located within the project area or in Perry County,</p>

1968, particularly section 7(b) and (c)	<input type="checkbox"/> <input checked="" type="checkbox"/>	Kentucky.
ENVIRONMENTAL JUSTICE		
Environmental Justice Executive Order 12898	Yes <input type="checkbox"/> No <input checked="" type="checkbox"/>	No impact. The project will benefit all area residents regardless of any protected class. The Perry County Fiscal Court is an equal opportunity provider and will serve all potential customers equally.

Environmental Assessment Factors [24 CFR 58.40; Ref. 40 CFR 1508.8 &1508.27]
Recorded below is the qualitative and quantitative significance of the effects of the proposal on the character, features and resources of the project area. Each factor has been evaluated and documented, as appropriate and in proportion to its relevance to the proposed action. Verifiable source documentation has been provided and described in support of each determination, as appropriate. Credible, traceable and supportive source documentation for each authority has been provided. Where applicable, the necessary reviews or consultations have been completed and applicable permits of approvals have been obtained or noted. Citations, dates/names/titles of contacts, and page references are clear. Additional documentation is attached, as appropriate. **All conditions, attenuation or mitigation measures have been clearly identified.**

Impact Codes: Use an impact code from the following list to make the determination of impact for each factor.

- (1) Minor beneficial impact
- (2) No impact anticipated
- (3) Minor Adverse Impact – May require mitigation
- (4) Significant or potentially significant impact requiring avoidance or modification which may require an Environmental Impact Statement

Environmental Assessment Factor	Impact Code	Impact Evaluation
LAND DEVELOPMENT		
Conformance with Plans / Compatible Land Use and Zoning/ Scale and Urban Design	1	The project is anticipated to have a positive impact to the proposed areas by installing infrastructure to provide continued water supplies to businesses and residents in times of emergency.
Soil Suitability/ Slope/ Erosion/ Drainage/ Storm Water Runoff	2	Appropriate erosion control measures will be utilized to minimize potential impacts.

Hazards and Nuisances including Site Safety and Noise	2	Adequate safety measures will be in place to protect motorists and construction workers.
Energy Consumption	2	The contractor will be required to use EPA compliant equipment during construction. The Perry County Fiscal Court will encourage Green Building Techniques and Energy Efficient Design Components for the project.

Environmental Assessment Factor	Impact Code	Impact Evaluation
SOCIOECONOMIC		
Employment and Income Patterns	1	No impacts. The project will not create any new jobs. The project will provide a backup water source for the Appalachian Regional Commission and several other businesses in the Hazard area. The backup water source will ensure businesses are still operational in times of emergency water situations.
Demographic Character Changes, Displacement	2	No impact. The project will not displace any families nor will it require residents to relocate.

Environmental Assessment Factor	Impact Code	Impact Evaluation
COMMUNITY FACILITIES AND SERVICES		
Educational and Cultural Facilities	1	The project will have an impact on two educational facilities in the Hazard area. The project will provide a backup water source for these educational facilities.
Commercial Facilities	1	This project will not construct any commercial facilities. The improved infrastructure will allow for commercial facilities in the project area to have continued water services during emergency situations.
Health Care and Social Services	1	The project is located within a rural area with access to adequate medical and social services. This project will construct infrastructure that will supply continued water services to health care and social service facilities in times of emergency.
Solid Waste Disposal / Recycling	2	No impact. The project is located in an area with access to adequate solid waste disposal.

Waste Water / Sanitary Sewers	2	No impact. The project will not have an impact on existing sewer service.
Water Supply	1	The project will provide the necessary infrastructure for water service to serve the residents and businesses during emergency situations.
Public Safety - Police, Fire and Emergency Medical	1	The project is located within a rural area with access to adequate policing services, fire services, and emergency services.
Parks, Open Space and Recreation	2	The project will have no impact on parks, open space and recreation to area residents.
Transportation and Accessibility	2	The contractor(s) must comply with all safety regulations and assure adequate measures for traffic and workers.

Environmental Assessment Factor	Impact Code	Impact Evaluation
NATURAL FEATURES		
Unique Natural Features, Water Resources	2	No adverse impacts anticipated on Unique Natural Features because of the project.
Vegetation, Wildlife	2	The project is located on a previously disturbed mining site or highway right-of-way and existing easements. There will be a quarter acre of tree removal on the previously disturbed mining site. Per response from Jennifer Garland dated May 12, 2020, the US Fish and Wildlife states, "Significant impacts to federally-listed species are not likely to result from this project as currently proposed. Project re-coordination is needed if the project changes or if new species or critical habitats are listed that could be impacted by the project."
Other Factors	2	No other factors have been identified.

Additional Studies Performed: Air Quality Attainment Report, Air Quality Index, Wild and Scenic River report, Contamination and Toxic Substance Report, Sole Source Aquifers

Field Inspection (Date and completed by): March 26, 2020, Kasey Malone, Kentucky River Area Development District

List of Sources, Agencies and Persons Consulted [40 CFR 1508.9(b)]:

- **Ky State Clearinghouse, Lee Nalley**
- **U S Fish and Wildlife, Virgil Lee Andrews, Jr.**
- **Natural Resources Conservation Services, Perri Pedley**
- **State Historic Preservation Officer, Craig A. Potts**
- **Division of Waste Management**
- **Division of Water**
- **KY Fish and Wildlife, Dan Stoelb**
- **Eastern Band of Cherokee Indians, Russ Townsend**
- **Division of Air Quality**
- **Division of Waste Management**
- **FEMA**
- **Division of Flood Plain Management**
- **U.S. Army Corps of Engineers – Louisville District Eastern Kentucky, Justin Branham**

List of Permits Obtained:

- **May 20, 2020 - Kentucky Transportation Cabinet Encroachment Permit. Permit #: 12-2020-00083**
- **June 23, 2020 – Department for Environmental Protection Stream Construction Permit. Permit #: 29958**

Public Outreach [24 CFR 50.23 & 58.43]:

- **May 21, 2020 - Floodplains and Wetlands Early Public Notice Activity in a 100-year Floodplain**
- **June 11, 2020 - Floodplain and Wetland Notice of Explanation Activity in a 100-year Floodplain**
- **July 3, 2020 - Combined Notice to Public of No Significant Effect on the Environment and Notice to Public of Request for Release of Funds.**

Cumulative Impact Analysis [24 CFR 58.32]:

It is highly anticipated the project will have a positive impact on the proposed area by constructing, installing, and rehabilitating public infrastructure that will continue to provide water services to residents and businesses of Perry County. The Perry County Fiscal Court has determined the project will have no significant impact on the human environment. They will take measures to ensure erosion control measures to reduce impact to the aquatic environment. There is approximately a quarter acre of anticipated tree removal on previously disturbed abandon mine land. There are no significant impacts to federally listed endangered or threatened species anticipated.

Alternatives [24 CFR 58.40(e); 40 CFR 1508.9]

Alternative #1: The preferred alternative is to construct the project as designed. This alternative has been deemed the most advantageous and environmentally sound. The construction of this project will greatly increase the quality of life for residents in the area.

Alternative #2: Build a new water treatment plant – This would not be an ideal alternative as constructing a new water treatment plant would require additional funding and would most likely require mitigation as a new project site would have to be selected and a source of water would have to be determined.

No Action Alternative [24 CFR 58.40(e)]: The least preferred alternative is to do nothing. This alternative would see residents and local businesses go without water services in emergency situations.

Summary of Findings and Conclusions: The proposed project will overall have a positive environmental impact as well as an economic impact on Perry County, Kentucky. The project will provide continued water services to residents and businesses in times of emergency. The only mitigation required is erosion control. The Perry County Fiscal Court will take all measures to ensure erosion control measures are utilized during project construction.

Mitigation Measures and Conditions [40 CFR 1505.2(c)]

Summarize below all mitigation measures adopted by the Responsible Entity to reduce, avoid, or eliminate adverse environmental impacts and to avoid non-compliance or non-conformance with the above-listed authorities and factors. These measures/conditions must be incorporated into project contracts, development agreements, and other relevant documents. The staff responsible for implementing and monitoring mitigation measures should be clearly identified in the mitigation plan.

Law, Authority, or Factor	Mitigation Measure
KY Fish and Wildlife	Erosion control measures will be developed and implemented to reduce siltation into waterways. These erosion control measures may include silt fences, staked straw bales or other measures.
Division of Water	Best management practices should be utilized to reduce runoff from project construction activities into nearby waters.

Determination:

- Finding of No Significant Impact [24 CFR 58.40(g)(1); 40 CFR 1508.27]**
The project will not result in a significant impact on the quality of the human environment.

- Finding of Significant Impact [24 CFR 58.40(g)(2); 40 CFR 508.27]**
The project may significantly affect the quality of the human environment.

Preparer Signature: _____ Date: _____

Name/Title/Organization: Angelia Hall/Associate Director, CED/Kentucky River Area Development District.

Certifying Officer Signature: _____ Date: _____
Name/Title: Scott Alexander, Judge Executive

This original, signed document and related supporting material must be retained on file by the Responsible Entity in an Environmental Review Record (ERR) for the activity/project (ref: 24 CFR Part 58.38) and in accordance with recordkeeping requirements for the HUD program(s).

ENVIRONMENT REVIEW STATUS

Exempt

Administration
Planning
Historic and Environmental Studies
Engineering

Categorically Excluded

Assessment

Water lines – construct/replace approximately 6,449 LF of 8” PVC and 2,458 LF of 6” PVC.
Water Storage Tank – construct one 250,000 gallon tank.
Booster Pump Station – construct/rehabilitate four pump stations.
Meters – construct three interconnection meters.

DLG Environmental Submittal Checklist

Project/Program Name: KY RT 80/KY RT 476 Interconnection Project

Project/Program ID Number: KY201909071177/19A-040

Project Location (if applicable): KY HWY 80/476, Hazard, Kentucky 41701

Level of Environmental Review Completed:

Date Commitment and Expenditure of Funds was authorized by the Responsible Entity/Environmental Certifying Officer: _____

Exempt [§58.34(a)] Date completed: _____

Environmental Review Status Form submitted to KY DLG Date: _____

Exempt/CENST determination form

Request for Approval of Evidentiary Materials and Release of Funds submitted to KY DLG with copy of the above completed form Date: _____

Categorically excluded *not subject to* §58.5 [§58.35(b)]

Date completed: _____

Environmental Review Status Form submitted to KY DLG Date: _____

Exempt/CENST determination form

Request for Approval of Evidentiary Materials and Release of Funds submitted to KY DLG with copy of the above completed form Date: _____

Categorically excluded *subject to* §58.5 [§58.35(a)]:

Converted to exempt (§ 58.35(a)(12)) Date converted: _____

OR

NOI/RROF published Date: _____

Environmental Certification submitted to KY DLG Date: _____

Request for Approval of Evidentiary Materials and Release of Funds submitted to KY DLG Date: _____

Environmental Review Status Form-submitted to KY DLG

KY State eClearinghouse comments-submitted to KY DLG

KY Heritage Council-SHPO comments and approval- submitted to KY DLG

All required publication(s) tear sheets- submitted to KY DLG

KY DLG Approval received Date signed by KY DLG: _____



Environmental Assessment (§58.36)

FONSI/NOI published Date: 07/03/2020

Environmental Certification submitted to KY DLG Date: _____

Request for Approval of Evidentiary Materials and Release of Funds submitted to KY DLG Date: _____

Environmental Review Status Form submitted to KY DLG Date: _____

KY State eClearinghouse comments submitted to KY DLG: 02/05/2020

KY Heritage Council-SHPO comments and approval- submitted to DLG: 04/03/2020

All required publication(s) tear sheets- submitted to KY DLG: _____

KYDLG approval received Date signed by KY DLG: _____

ENVIRONMENTAL REVIEW RECORD CHECKLIST

- Finding of Exemption and/or Categorical Exclusion not Subject to
- Statutory Checklist and all supporting documentation
- Historic Preservation Procedures Completed and Documented including Tribal Consultation
- Floodplains/Wetlands Procedures Completed and Documented
 - Early Public Notice Published
 - Notice of Explanation Published
- Environmental Assessment and Checklist (Format II) and all /supporting documentation
- Notice of Intent to Request Release of Funds (NOIRROF) Publication (tear sheet)
- Concurrent Notice of Finding and No Significant Effect and Notice of Intent to Request Release of Funds (FONSI-NOIRROF) (tear sheet)
- Notice of Availability of Environmental Assessment (if joint project with Rural Development only) N/A
- Distribution List for all Public Notices
- Comments Received and City/County responses: **No comments received.**
- Environmental Certification, Request for Approval of Evidentiary Materials and Release of Funds Submitted
- Post-Review Revisions and Changes, Written Decisions, Amendments and Supplements

(This listing is for all types of possible projects. For a more complete listing of required documentation for the ERR as it relates to a specific type of project, see Section 58.30 of the regulations and the Handbook Chapter 2.)

Exhibit 1
Clearinghouse Comments



ANDY BESHEAR
GOVERNOR

DEPARTMENT FOR LOCAL GOVERNMENT
OFFICE OF THE GOVERNOR
100 AIRPORT ROAD, 3rd FLOOR
FRANKFORT, KENTUCKY 40601-8204
PHONE (502) 573-2382 FAX (502) 573-2939
TOLL FREE (800) 346-5606/ TDD:711
WWW.kydlgweb.ky.gov

DENNIS KEENE
COMMISSIONER

March 9, 2020

Judge Scott Alexander
Perry County Fiscal Court
P.O. Drawer 210
Hazard, KY 41702

RE: KY RT 80/KY RT 476 Interconnect Project
WX21193040
SAI# KY202002050085
CFDA# 23.002

Dear Judge Alexander:

The Kentucky State e-Clearinghouse is the official designated Single Point of Contact (SPOC) for the Commonwealth pursuant to Presidential Executive Order 12372, and supported by Kentucky Statutes KRS 45.031. The primary function of the SPOC is to streamline the review aforementioned process for the applicant and the funding agency. This process helps in vocalizing the statutory and regulatory requirements. Information in the form of comments, if any, will be attached to this correspondence.

This proposal has been reviewed by the appropriate state agencies in the e-Clearinghouse for conflicts with state or local plans, goals and objectives. After receiving this letter, you should make it available to the funding agency and continue with the funding agencies application process. This e-clearinghouse SPOC letter signifies only that the project has followed the state reviewing requirements, and is neither a commitment of funds from this agency or any other state or federal agency. Please remember if any federal reviews are required the applicant must follow through with those federal agencies.

The results of this review are valid for one year from the date of this letter. If the project is not submitted to the funding agency or not approved within one year after the completion of this review, the applicant can request an extension by email to Lee.Nalley@ky.gov. If the project changes in any way after the review, the applicant must reapply through the eclearinghouse for a new review. There are no exceptions.

If you have any questions regarding this letter or the review process please contact the e-Clearinghouse office at 502-573-2382, ext. 274.

Sincerely,

Lee Nalley, SPOC
Kentucky State Clearinghouse

Attachment

Department for Environmental Protection

Louanna Aldridge

Joel Murphy - Endorse with Comments The proposed project is subject to Division of Water (DOW) jurisdiction because the following are or appear to be involved: water lines and appurtenances. Prior approval must be obtained from the DOW before construction can begin. The applicant must cite the State Application Identifier (SAI #KY202002050085) when submitting plans and specifications.

The Perry County Fiscal Court is working to interconnect the systems of Knott County Water and Sewer District and the City of Hazard. Recently with cold weather, the City of Hazard has experienced issues with supplying water to the Village of Buckhorn. This project should assist in alleviating some of these issues in the future. It will also assist in alleviating issues to Appalachian Regional Healthcare (ARH) and the Industrial Park should they arise. The project proposes to upgrade the Knott County Water and Sewer District (KCWSD) distribution system at its terminus at the Knott/Perry county line on KY 80. Upgrades will include modifying and upgrading 2 existing booster pump stations (BPS). The Irishman Creek BPS will require a minimum upgrade of pumps and variable frequency drive (VFD) controls to increase the current flow capacity as well as the in-series Montgomery Creek BPS will require matching upgrade capacity. A new BPS will be required along Route 80 to pump to a new ground storage tank which be constructed near the Knott/Perry County line on the Knott County side (location, capacity to be determined, designed and land acquired). Another booster pump station on the Perry County side will also be constructed located at Red Star. The tank will gravity flow thru a new +/- 6,000 linear feet of 8-inch SDR-17 PVC transmission line and tie into the Perry County system near the intersection of Route 80 and Route 476. Master meter and isolation valves with Supervisory Control and Data Acquisition (SCADA) control will be installed along the 8-inch interconnect for wholesale service from KCWSD to the City of Hazard. There will also be two additional interconnections between the KCWSD and the City of Hazard. The first will be at Ball Fork and will extend approximately +/- 400 linear feet of 6-inch PVC transmission line and the second will be at West Highway 550 and will extend approximately +/- 2,100 linear feet of 6-foot PVC transmission line and provide SCADA controls and master meters. With these upgrades, KCWSD can supply up to 500,000 gallons per day of additional water to Perry County. The County is currently seeking funds for this project and it is their number one priority at this time.

This project will likely help to increase Technical, Managerial, and Financial (TMF) capacity for the Hazard Water Department. Any recommendations listed within the Sanitary Survey results letter (dated October 31, 2019,) which have not already been implemented, are still highly advised. Questions should be directed to Jennifer Taimi, Municipal Planning Section, (502) 782-7087, Jennifer.Taimi@ky.gov.

Submit all plans and specifications to DOW for review and approval prior to the start of construction. Additionally, if this is a new interconnect, ensure disinfection protocols for both treatment plants are compatible with each other. Questions should be directed to Mollye Malone, Engineering Section, (502) 782-0148, Mollye.Malone@ky.gov.

Best management practices should be utilized to reduce runoff from project construction activities into nearby waters. Questions should be directed to Andrea Fredenburg, Water Quality Branch, (502) 782-6950, Andrea.Fredenburg@ky.gov.

The portion of the project involving the pump station along Big Branch Road is within the Hazard Water District designated Source Water Protection Area, Zone 3 (Zone of Potential Impact). Questions should be directed to Chloe Brantley, Water Supply Section, (502) 782-6898, Chloe.Brantley@ky.gov.

Endorse. Questions should be directed to Daniel Fraley, Field Operations Branch, (606) 783-8655, Daniel.Fraley@ky.gov.

The proposed work is endorsed by the Groundwater Section of the Watershed Management Branch. However, there are domestic groundwater water well users in the vicinity of the proposed work. It is our recommendation that site be made aware of the requirements of 401 KAR 5:037 and the need to develop a Groundwater Protection

Plan (GPP) for the protection of groundwater resources within that area. Questions should be directed to Adam Nolte, Groundwater Section, (502) 782-1312, Adam.Nolte@ky.gov or Kurtis Spears, Groundwater Section, (502) 782-7119, Kurtis.Spears@ky.gov.

For pipeline stream crossings that are not covered under 401 KAR 4:050, a Kentucky DOW Application for Permit to Construct Across or Along a Stream must be submitted. Questions should be directed to Shawn Hokanson, Floodplain Management Section, (502) 782-6977, Shawn.Hokanson@ky.gov.

The Division of Enforcement does not object to the project proposed by the applicant. Questions should be directed to Tim Harrod, Division of Enforcement, (502) 782-6858, Timothy.Harrod@ky.gov.

If the construction area disturbed is equal to or greater than 1 acre, the applicant will need to apply for a Kentucky Pollutant Discharge Elimination System (KPDES) storm water discharge permit.

Utility line projects that cross a stream will require a Section 404 permit from the US Army Corps of Engineers and a 401 Water Quality Certification from DOW.

The Kentucky Division of Water supports the goals of EPA's Sustainable Infrastructure Initiative. This Initiative seeks to promote sustainable practices that will help to reduce the potential gap between funding needs and spending at the local and national level. The Sustainable Infrastructure Initiative will guide our efforts in changing how Kentucky views, values, manages, and invests in its water infrastructure. This website, www.epa.gov/waterinfrastructure/, contains information that will help you ensure your facility and operations are consistent with and can benefit from the aims of the Sustainable Infrastructure Initiative.

Department of Housing, Buildings and Construction

Kevin Carlin

The Department of Housing Buildings and Construction, Division of Building Code Enforcement, has no comments concerning this proposed project. Please contact this office to inquire about the requirements for required permitting.

Division of Enforcement

Tim Harrod

The Division of Enforcement does not object to the project proposed by the applicant.

Tim Harrod, Enforcement Specialist

Division of Enforcement

Timothy.Harrod@ky.gov

Division of Water

Andrea Fredenburg

Best management practices should be utilized to reduce runoff from project construction activities into nearby waters.

DOW

Daniel Fraley

Endorse

Division of Water

Jennifer Taimi

This project will likely help to increase TMF capacity for the Hazard Water Department. Any recommendations listed within the Sanitary Survey results letter (dated October 31, 2019,) which have not already been implemented, are still highly advised.

Fish and Wildlife

Dan Stoelb

To minimize impacts to the aquatic environment the Kentucky Dept. of Fish & Wildlife Resources recommends that erosion control measures be developed and implemented prior to construction to reduce siltation into waterways located within the project area. Such erosion control measures may include, but are not limited to silt fences, staked straw bales, brush barriers, sediment basins, and diversion ditches. Erosion control measures will need to be installed prior to construction and should be inspected and repaired regularly as needed. Please contact Dan Stoelb @ 502-892-4453 or Daniel.Stoelb@ky.gov if you have further questions or require additional information.

Kentucky Division of Water

Chloe Brantley

Project filed.

Kentucky Infrastructure Authority

Don Schierer

This project was reviewed in the WRIS Portal by KIA staff.

Kentucky River Area Development District

Angelia Hall

For File

Kentucky Transportation Cabinet (10)

Jason Blackburn (D 10)

Applicant must acquire approved Highway Encroachment Permit before applicant or its contractors begin any work on Commonwealth Right of Way.

KY Division of Water

Allan Shingleton

For pipeline stream crossings that are not covered under 401 KAR 4:050, a Kentucky Division of Water Application for Permit to Construct Across or Along a Stream must be submitted. Questions should be directed to Shawn Hokanson at 502-782-6977 or Shawn.Hokanson@ky.gov.

The portion of the project involving the pump station along Big Branch Road is within the Hazard Water District designated Source Water Protection Area, Zone 3 (Zone of Potential Impact). Questions should be submitted to Chloe Brantley at 502-782-6898 or Chloe.Brantley@ky.gov.

KY Heritage Council

Yvonne Sherrick

To receive a review from the KY Heritage Council/State Historical Preservation Office (SHPO) you must follow the instructions located on their website at <http://www.heritage.ky.gov/siteprotect/>. There you will find the required documents for the Section 106 Review and Compliance for 36 CFR Part 800. This Section 106 submission process to SHPO will assist applicants and agencies in providing the appropriate level of information to receive comments from SHPO. If you have any questions please contact Yvonne Sherrick, Administrative Specialist III, (502) 564-7005, Ext. 113, yvonne.sherrick@ky.gov.

Please note: If your project is funded through Transportation Alternative (TAP), Transportation Enhancements (TE), Congestion, Mitigation, Air Quality (CMAQ), or Safe Routes to School (SRTS) you will need to send this information to Michael Jones, Historic Preservation Program Administrator with the Kentucky Transportation Cabinet via email MichaelR.Jones2@ky.gov or hard copy to Michael Jones, Office of Local Programs, KY Transportation Cabinet, 200 Mero Street Frankfort, KY 40622. Do not send materials directly to SHPO if your project involves funding from these four sources as it will cause delays in the review process. Michael Jones will consult directly with the SHPO on projects with these funding sources to complete the Section 106 review.

KY. Division of Water

Kurtis Spears

The proposed work is endorsed by the Groundwater Section of the Watershed Management Branch. However, there are domestic groundwater water well users in the vicinity of the proposed work. It is our recommendation that site be made aware of the requirements of 401 KAR 5:037 and the need to develop a Groundwater Protection Plan (GPP) for the protection of groundwater resources within that area. Questions should be directed to Adam Nolte (502-782-1312) or Kurtis Spears (502-782-7119).

Water Infrastructure Branch - DOW

Mollye Malone

Submit all plans and specifications to DOW for review and approval prior to the start of construction. Additionally, if this is a new interconnect, ensure disinfection protocols for both treatment plants are compatible with each other.

Exhibit 2
State Historic Preservation Officer (SHPO)
Correspondence



ANDY BESHEAR
GOVERNOR

TOURISM, ARTS AND HERITAGE CABINET
KENTUCKY HERITAGE COUNCIL
THE STATE HISTORIC PRESERVATION OFFICE

MIKE BERRY
SECRETARY

410 HIGH STREET
FRANKFORT, KENTUCKY 40601
PHONE (502) 564-7005
FAX (502) 564-5820
www.heritage.ky.gov

CRAIG A. POTTS
EXECUTIVE DIRECTOR
& STATE HISTORIC
PRESERVATION OFFICER

April 17, 2020

Angelia Hall
Kentucky River Area Development Dist.
941 N. Main St.
Hazard, KY 41701

Re: **KY RT 80/KY RT 476 Interconnect Project (WX21193040), Hazard, Perry Co., KY**

Dear Ms. Hall:

Our review indicates that the proposed project will not impact any properties or sites that are listed in or eligible for the National Register of Historic Places. The proposed project should not require an archaeological survey or cultural historic survey.

In the event that human remains are encountered during project activities, all work should be immediately stopped in the area. The area should be cordoned off, and in accordance with KRS 72.020 the county coroner and local law enforcement must be contacted immediately. Upon confirmation that the human remains are not of forensic interest, the unanticipated discovery must be reported to the Kentucky Heritage Council.

Should the project plans change, or should additional information become available regarding cultural resources or citizens' concerns regarding impacts to cultural resources, please submit that information to our office as additional consultation may be warranted. Should you have any questions, feel free to contact Nick Laracuate of my staff at nicolas.laracuate@ky.gov.

Sincerely,

Craig A. Potts,
Executive Director and
State Historic Preservation Officer

CP:nrl KHC #57881



Kentucky River AREA DEVELOPMENT DISTRICT

941 N. MAIN ST. • HAZARD, KENTUCKY 41701 • PHONE 606-436-3158

April 3, 2020

CHAIRMAN
Pam Pilgrim **VICE-CHAIRMAN** Tracy Neice
Mayor
TREASURER
Terry Adams
Judge/Executive
SECRETARY
Gregory Whitson
PARLIAMENTARIAN
Laura Thomas Mayor

BOARD OF DIRECTORS

County Judge Executives
Jeff Noble - Breathitt Co. Jeff Dobson - Knott Co. Chuck Caudill - Lee Co. William R. Lewis - Leslie Co. Terry Adams - Letcher Co. Cale Turner - Owsley Co. Scott Alexander - Perry Co. Raymond Banks - Wolfe Co.
Mayors
Laura Thomas - Jackson Tracy Neice - Hindman Scott Cornett - Pippa Passes Scott Jackson - Beattyville Carol Joseph - Hyden Susan Polis - Fleming-Neon James W. Craft - Whitesburg Todd DePriest - Jenkins Nelson Bobrowski - Booneville Ernest Back - Wicco Donald "Happy" Mobilini - Hazard Tom Burns - Buckhorn Kathi May - Campton
Citizen Members
Roy Darrell Herald Gary Campbell Ray D. Moore Larry Parke Larry Perkins Zach Sandlin Hiram Cornett Eugene Stewart Everett Marshall Doug Brandenburg Fred Hall Jack Burkich Dale Bishop Derrick Bowling Neil Napier Gregory Whitson Meriwether Wash-Hall Pam Pilgrim Shirley Halcomb

Executive Director
Michelle Allen

E-Mail: michelle@kradd.org
FAX NUMBER 606-436-2144
TDD NUMBER 1-800-247-2510
(Hearing Impaired)

Mr. Craig Potts
Executive Director/State Historic Preservation Officer
Kentucky Heritage Council
300 Washington Street
Frankfort, KY 40601

RE: KY RT 80/KY RT 476 Interconnect Project (WX21193040)

Dear Mr. Potts:

The Perry County Fiscal Court is in the process of conducting an environmental review pursuant to the State Environmental Review Process for an ARC Grant for the above reference project. The purpose of the review is to assess the environmental impacts of the KY RT 80/KY RT 476 Interconnect Project in Hazard, Kentucky.

Enclosed is the KHC cover sheet for Section 106 Review and Compliance containing project information. Also enclosed you will find project maps and photographs of the project site including anything over 50 years of age visible from the project site.

As documented by the maps and supporting documentation enclosed, there will be ground disturbance in previously disturbed highway right-of-way, existing easements, and on reclaimed abandoned mine land. Due to the nature of the project, we feel that there will be no effect on properties eligible for the Historic Register or on any historical structures. Please advise us of any present concerns your office may have related to possible effects of the above mentioned project.

We would appreciate a response within 30 days, if possible. If you need any further information or wish to discuss the project, please feel free to contact me at (606) 436-3158 or by email at angelia@kradd.org.

Sincerely,

Angelia Hall

Angelia Hall
Associate Director, CED

enclosures

CC: Perry County Fiscal Court/file

KENTUCKY HERITAGE COUNCIL COVER SHEET FOR SECTION 106 REVIEW AND COMPLIANCE

When federal (and some state) funds, permits or approvals are needed for a project, regulations such as 36 CFR Part 800 require these agencies or their delegates to consult with the Kentucky Heritage Council/State Historic Preservation Office regarding the project's potential effects on historic properties. To facilitate our review, please provide the following information and applicable attachments. Our office will generate a response within 30 days of receipt. Incomplete submissions may be returned for more information.

SECTION 1: APPLICANT INFORMATION	
Project Sponsor or Applicant: Perry County Fiscal Court	
Contact Person (name & position): Angelia Hall, Associate Director, CED	
Return Address: 941 North Main Street, Hazard, KY 41701	
Telephone: 606-436-3158	Fax: 606-436-2144
Project Title: KY RT 80/KY RT 476 Interconnect Project	
SECTION 2: AGENCY INFORMATION	
Funding/Permitting Agency: Appalachian Regional Commission (ARC)	
Agency Contact Person (name & position): Scott Sharp, ARC Program Manager	
Telephone: (502) 892-3476	E-mail: scott.sharp@ky.gov
SECTION 3: PROJECT LOCATION	
E911 Street Address (or other description): KY HWY 80 East and KY HWY 476	
City/Township: Hazard	County: Perry
Latitude: 37°21'22.931"N	Longitude: -83°6'49.754"W
SECTION 4: PROJECT TYPE (please check all that apply)	
Proposed Activity: <input type="checkbox"/> Demolition <input type="checkbox"/> Rehabilitation <input type="checkbox"/> Structural Relocation <input type="checkbox"/> Trails <input checked="" type="checkbox"/> New Construction <input type="checkbox"/> Land and/or Building Acquisition <input checked="" type="checkbox"/> Sewer/Water Lines <input type="checkbox"/> Roads/Bridges <input type="checkbox"/> Non-Construction Planning/Refinancing <input type="checkbox"/> Other (describe):	
SECTION 5: IDENTIFICATION OF KNOWN HISTORIC PROPERTIES	
KHC Preliminary Site Check #: 47161220	OSA Preliminary Site Check #: P246173
If your project involves ground disturbance, has the site been previously disturbed? <input checked="" type="checkbox"/> Yes (describe in detail below) <input type="checkbox"/> No This project will construct 6,400 Linear Feet of 8" and 2,500 Linear Feet of 6" waterline, a new water tank, two new pump stations, and rehab two pump stations throughout Perry and Knott County. All construction will be performed in previously disturbed highway right-of-way, existing easements, or on reclaimed mine land.	
Is there anything over 50 years of age in or visible from the project location? <input type="checkbox"/> Yes <input checked="" type="checkbox"/> No	
SECTION 6: ATTACHMENTS - Attach all as applicable	
<i>All documentation should be labeled with the project name or site address.</i> <input checked="" type="checkbox"/> Clear, current photographs of the project site and anything over 50 years of age in or visible from it. <input checked="" type="checkbox"/> Site map/plan indicating the exact location and boundaries of the project area. <input checked="" type="checkbox"/> Detailed description of the project (may include plans, scope of work, and other available information.) <input checked="" type="checkbox"/> Documentation of prior ground disturbance (e.g. maps, photographs, underground utility plans, etc.) <input checked="" type="checkbox"/> Any known information about the history/use of the property and local significance.	
Submit all information to Craig Potts, Executive Director/SHPO, Kentucky Heritage Council, 410 High Street, Frankfort, KY 40601.	

Project Description:

Perry County Fiscal Court in partnership with the City of Hazard will construct approximately 6,400 feet of 8" water main along KYHWY 80 east and KY 476 to connect the Knott County Water System to the City of Hazard Water System to provide potable water to approximately 1,500 customers – 3,435 citizens per 2010 census persons per household in the east central and Northern sections of Perry County during emergency water shortages, power outages, repairs to the City water system, and as a backup water supply to allow Hazard to better serve the Appalachian Regional Healthcare, Hazard Hospital complex and UK Center for Excellence in Rural Health Center. The project will also include a 250,000 gallon water storage tank, one new pressure booster pump station, and upgrade to 2 additional pressure booster pump stations with related appurtenances and master meter tie-in between Knott Co. Water system and City of Hazard Water System.

Kentucky Heritage Council

Site Identification Program

410 High Street, Frankfort, KY 40601

Confidential Information Not for Public Release

This information report includes only those historic resources within or near the project area that have been previously recorded with the Site Identification Program of the Kentucky Heritage Council and may not be exhaustive of all historic resources that are actually present. Note: this information report does not constitute Section 106 consultation or "clearance" from the KHC/SHPO.

KHC Preliminary Request #: 47161220

Preliminary Historic Resources Check Performed On: 1/3/2020

There were no previously recorded historic resources within or adjacent to your project area.

Kentucky Office of State Archaeology
University of Kentucky, 1020A Export Street, Lexington, KY 40506
Phone:859-257-1944 Fax:859-323-9866 email:ky-osa@uky.edu

Confidential Information
Not for Public Release

Preliminary Records Review Coversheet

Date Request Processed: 1/7/2020

Preliminary Review Number: P246173

Paid via: Check (Check No.:)

Credit Card (Transaction ID: 1421432964)

If you have any questions, please contact KyOSA at (859)257-1944 or ky-osa@uky.edu.

Kentucky Office of State Archaeology

University of Kentucky, 1020a Export Street, Lexington, KY 40506

Phone: (859)257-1944 Fax: (859)323-9866 email: ky-osa@uky.edu

Confidential Information; Not for Public Release

P246173

Knott County - City of Hazard Water System Connector

This report includes only previously recorded archaeological resources within your project area and its immediate vicinity and may not be exhaustive of all archaeological resources actually present. This information does not constitute Section 106 consultation or 'clearance' from the KHC/SHPO.

Date Request Filled: 01/07/20

Site Type

National Register Status

open habitation w/o mounds

National Register status not assessed

Kentucky Office of State Archaeology

University of Kentucky, 1020A Export Street, Lexington, KY 40506

Phone:(859)257-1944 Fax: (859)323-9866 Email: ky-osa@uky.edu

Confidential Information; Not for Public Release

P246173: Knott County - City of Hazard Water System Connector

Site Check Performed On: 01/07/20

060-016 578479 1990 Hand, Robert B.

A Coal Mine Survey along Troublesome Creek, in Knott and Perry County, Kentucky

060-018 578588 1990 Pecora, Albert M., III

A Coal Mine Survey along Bear Branch of Troublesome Creek, in Knott and Perry County, Kentucky

097-002 576413 1978 Gatus, Thomas W. and Thomas N. Sanders

A Reconnaissance and Evaluation of Archaeological Sites in Perry County

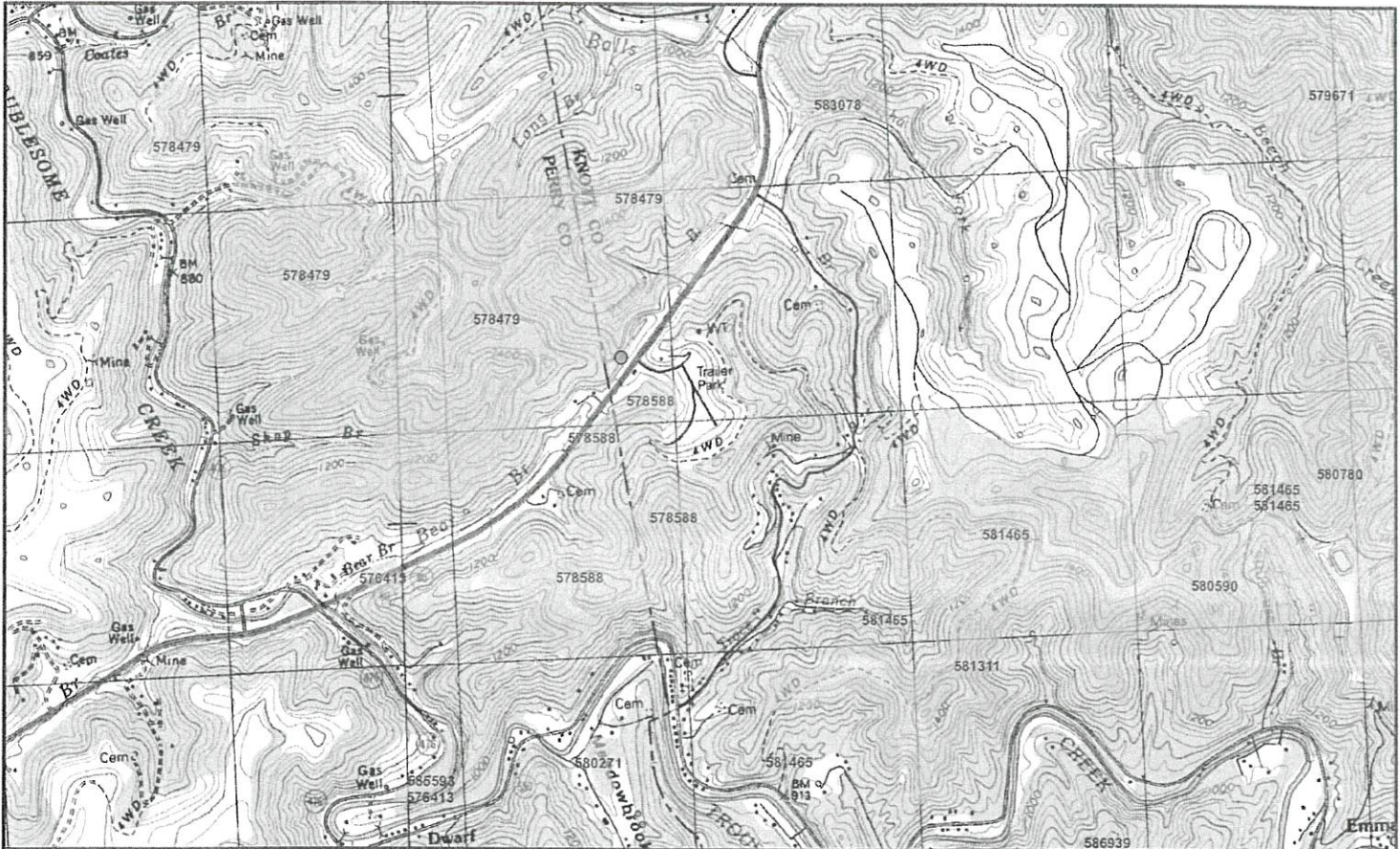

- Project Coordinates Submitted to OSA
- ▨ Previous Archaeological Survey Boundaries
- ▩ Phase 2 & 3 Archaeological Surveys

Note: Archaeological Site Locations NOT Shown



P246173
Knott County - City of Hazard Water System Connector

Kentucky Office of State Archaeology
 University of Kentucky, 1020A Export Street, Lexington, KY 40506
 phone: 859-257-8207 email: ky-osa@uky.edu

Confidential Information: Not for Public Release



Irishman Creek Pump Station upgrade site - Aerial View

GPS; 37°16'30.439"N

-82°59'49.8" W

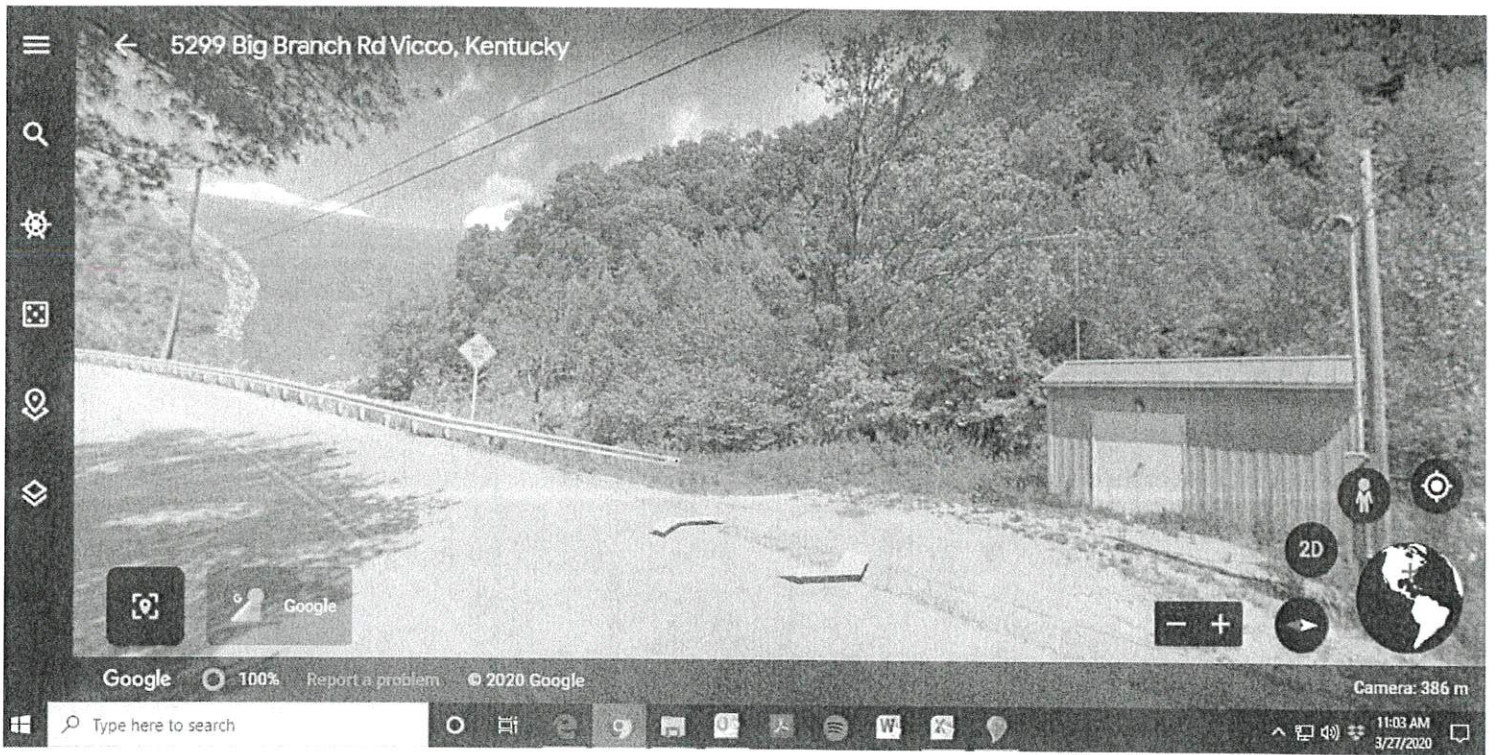

Irishman Creek Pump Station Upgrade - East View



Irishman Creek Pump Station Upgrade - North View



Irishman Creek Pump station Upgrade - South View

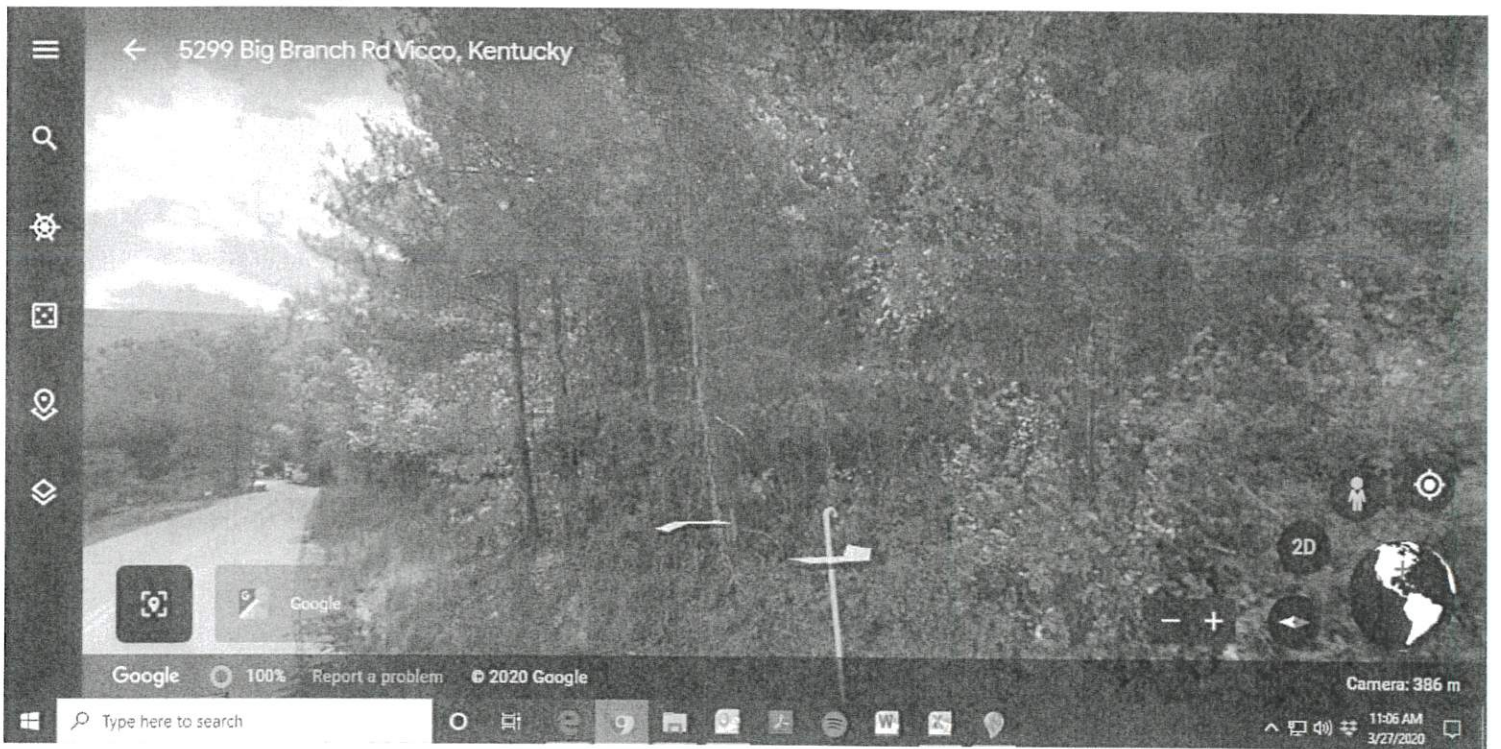

Irishman Creek Pump Station Upgrade - West View



KY 80, North site, New Pump Station - Aerial View

GPS: 37°22'4.21" N
- 83°6'26.301" W

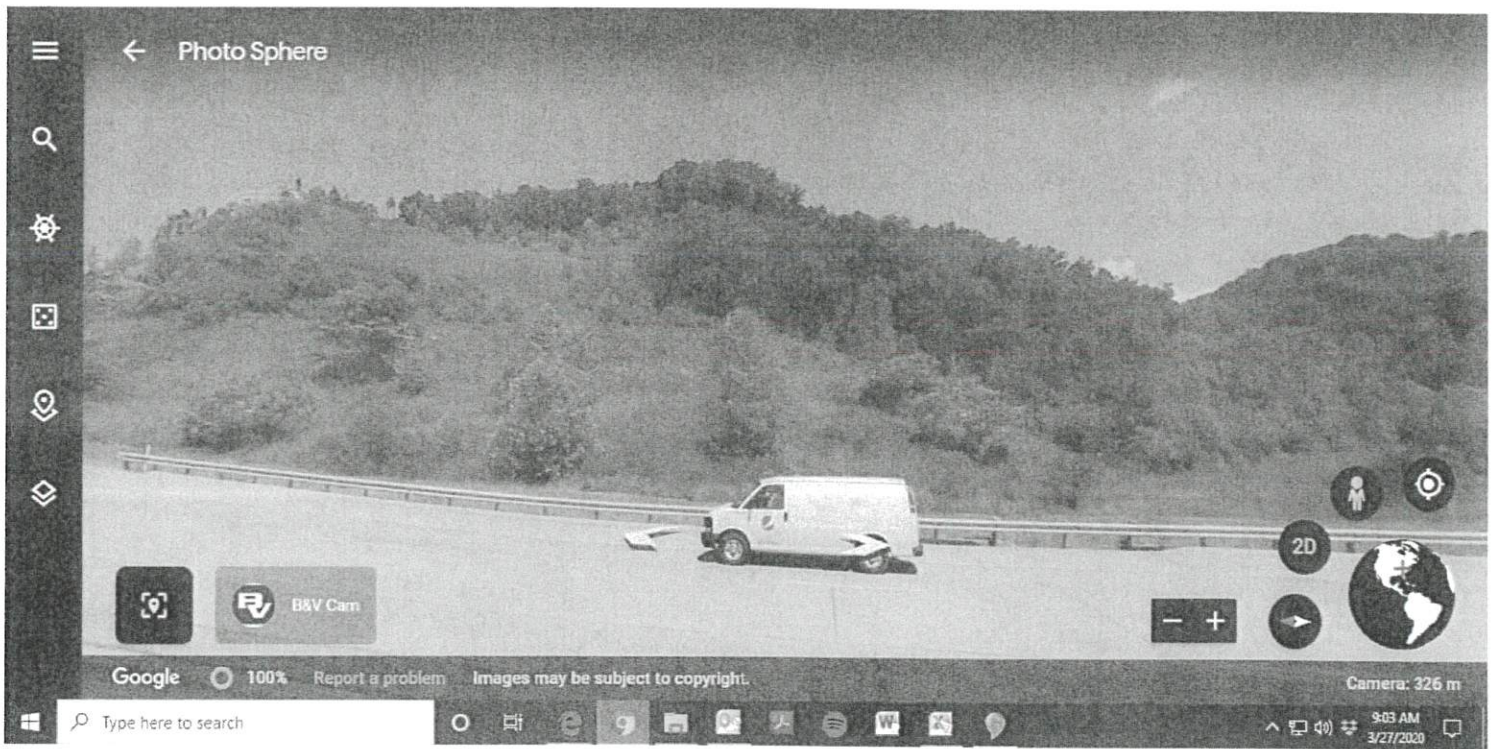

KY 80, North site, Pump Station - East View

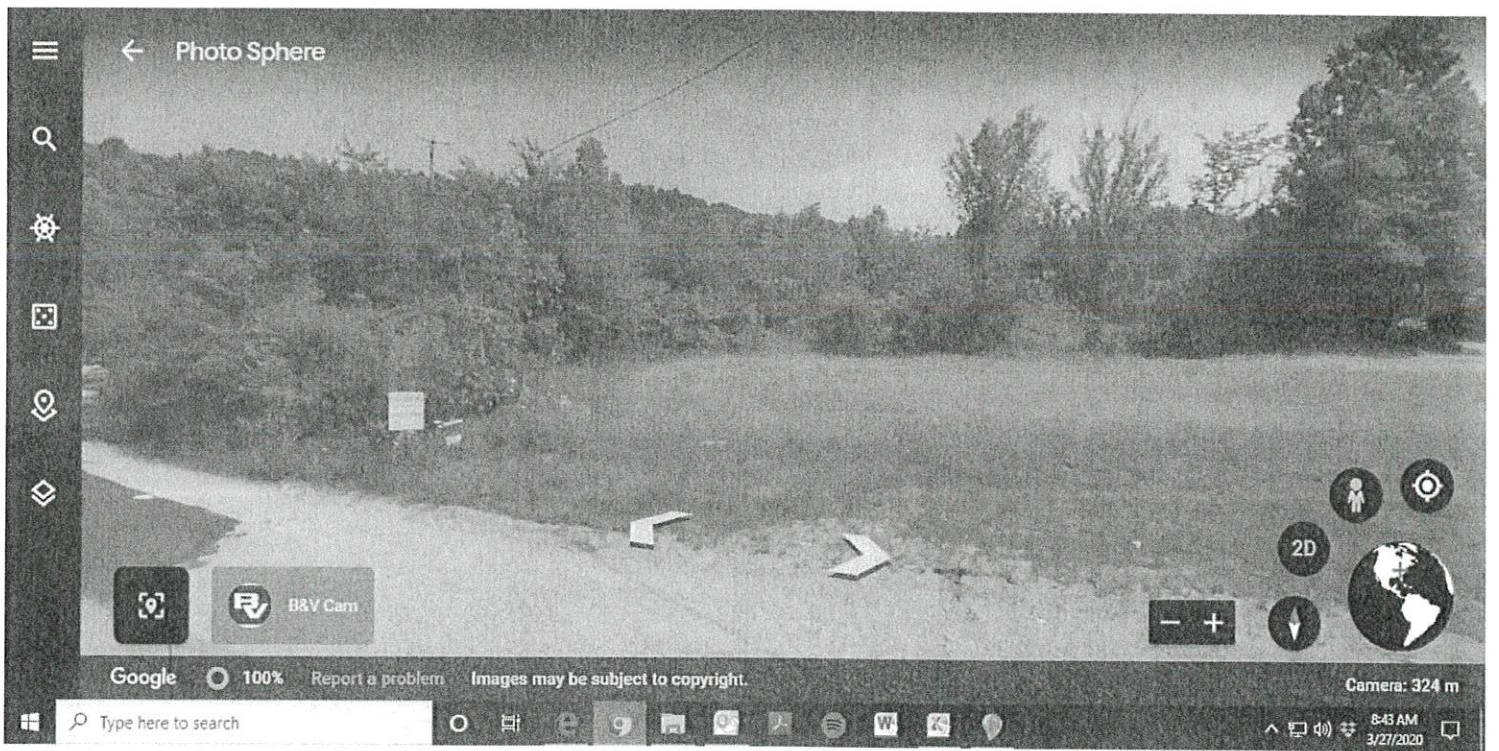

KY 80, North Site, New Pump Station - North View

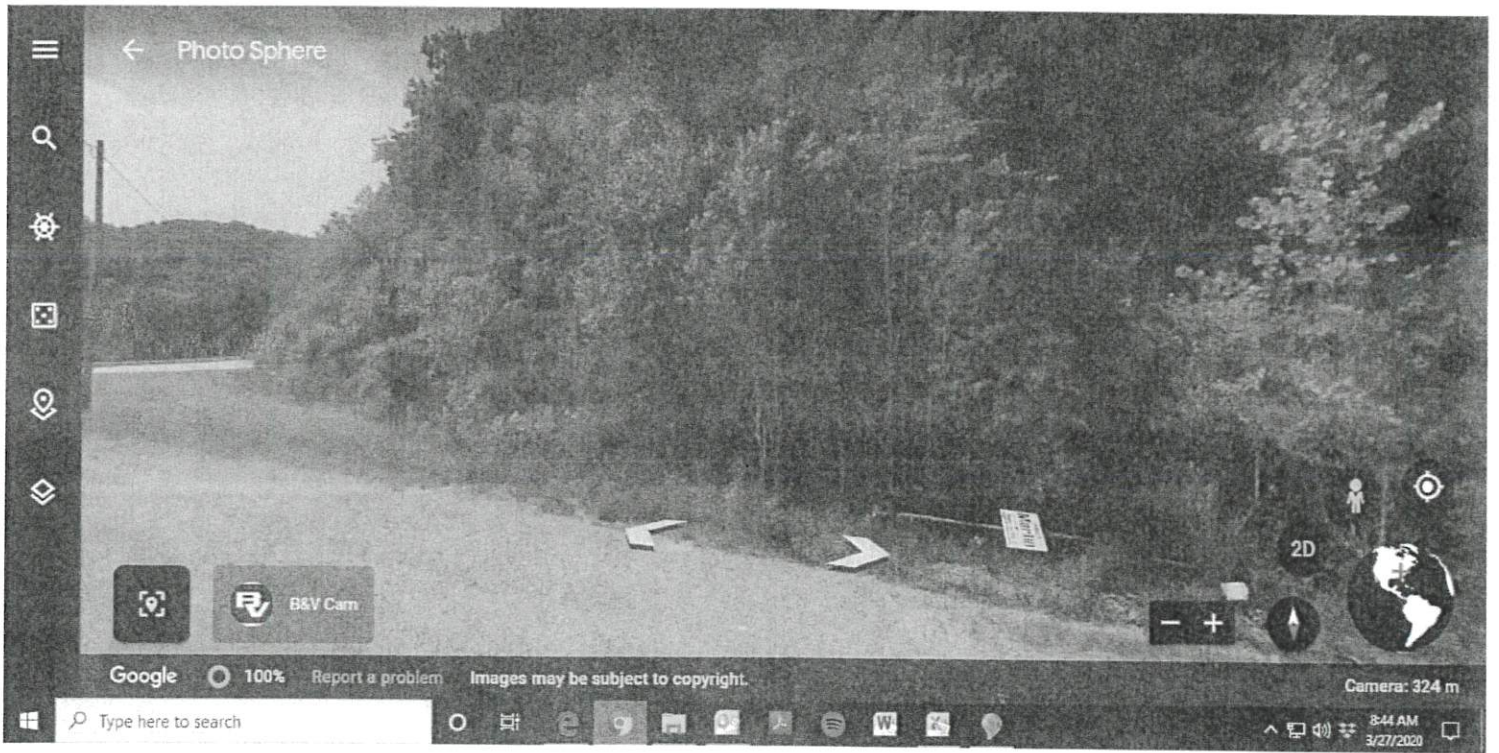

KY 80, North Site, New Pump Station ~ South View



KY 80, North Site, New Pump Station - West View



KY 80, South Side, New Pump Station - Aerial View

GPS: $37^{\circ}20'35.981''$ N
 $-83^{\circ}8'33.444''$ W

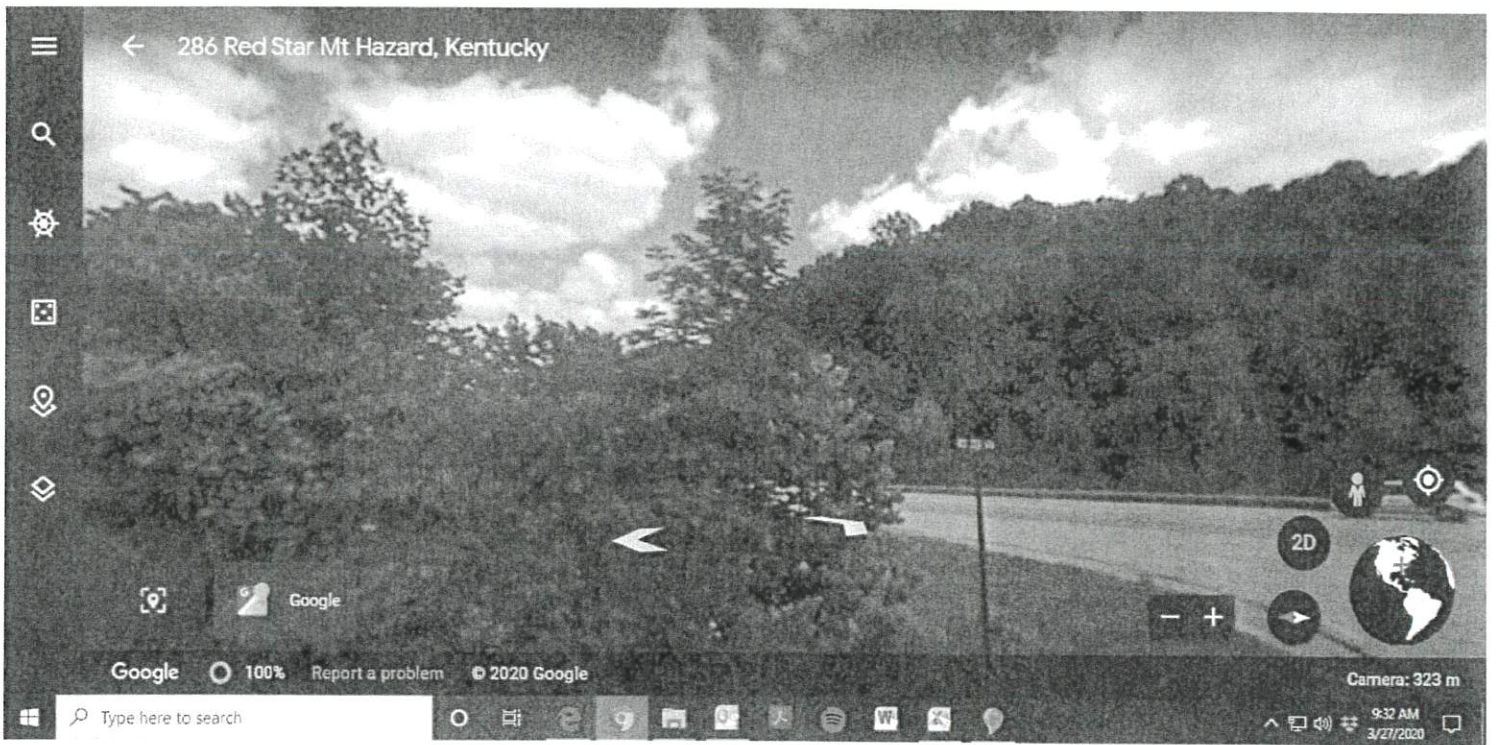

KY 80, South Site, New Pump Station - East View

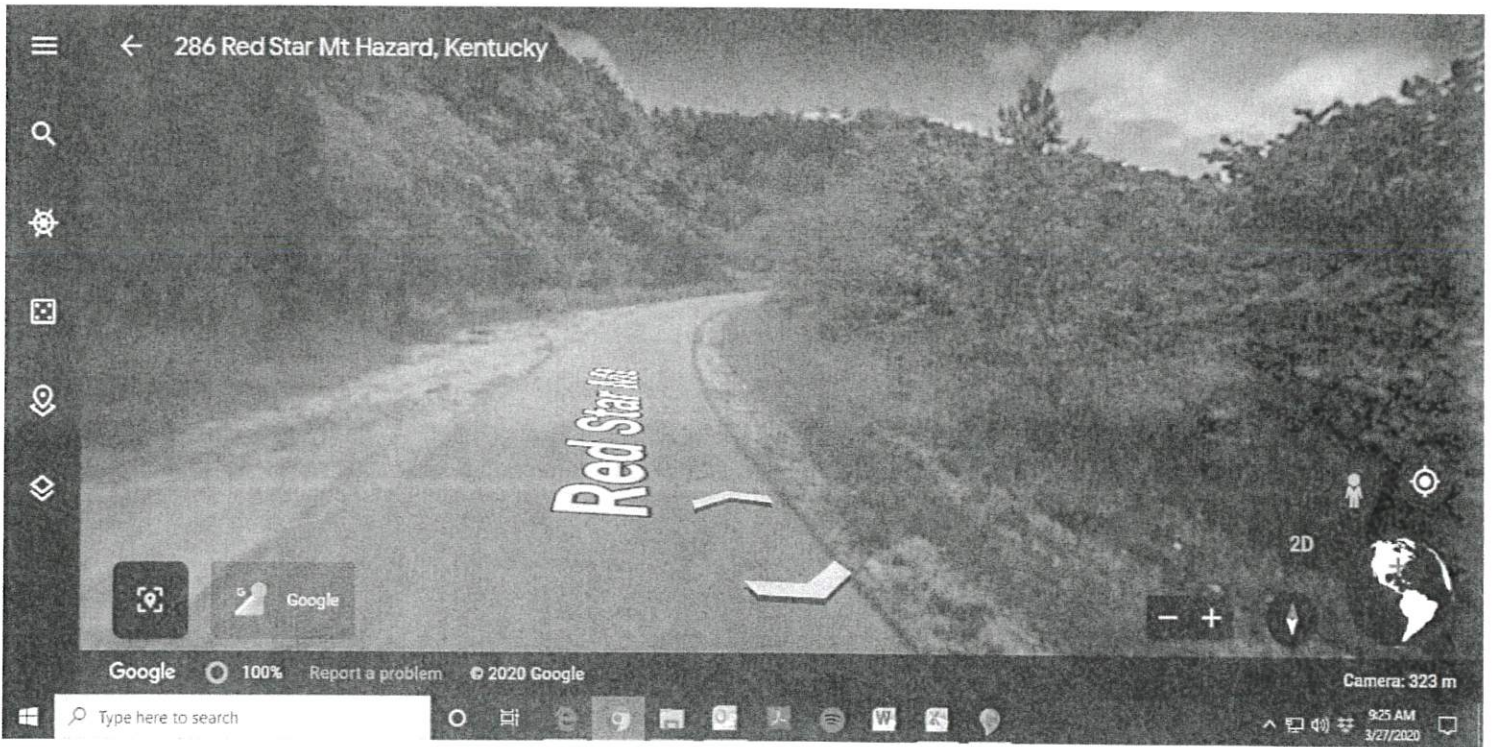

KY 80, South Site, New Pump Station - North View

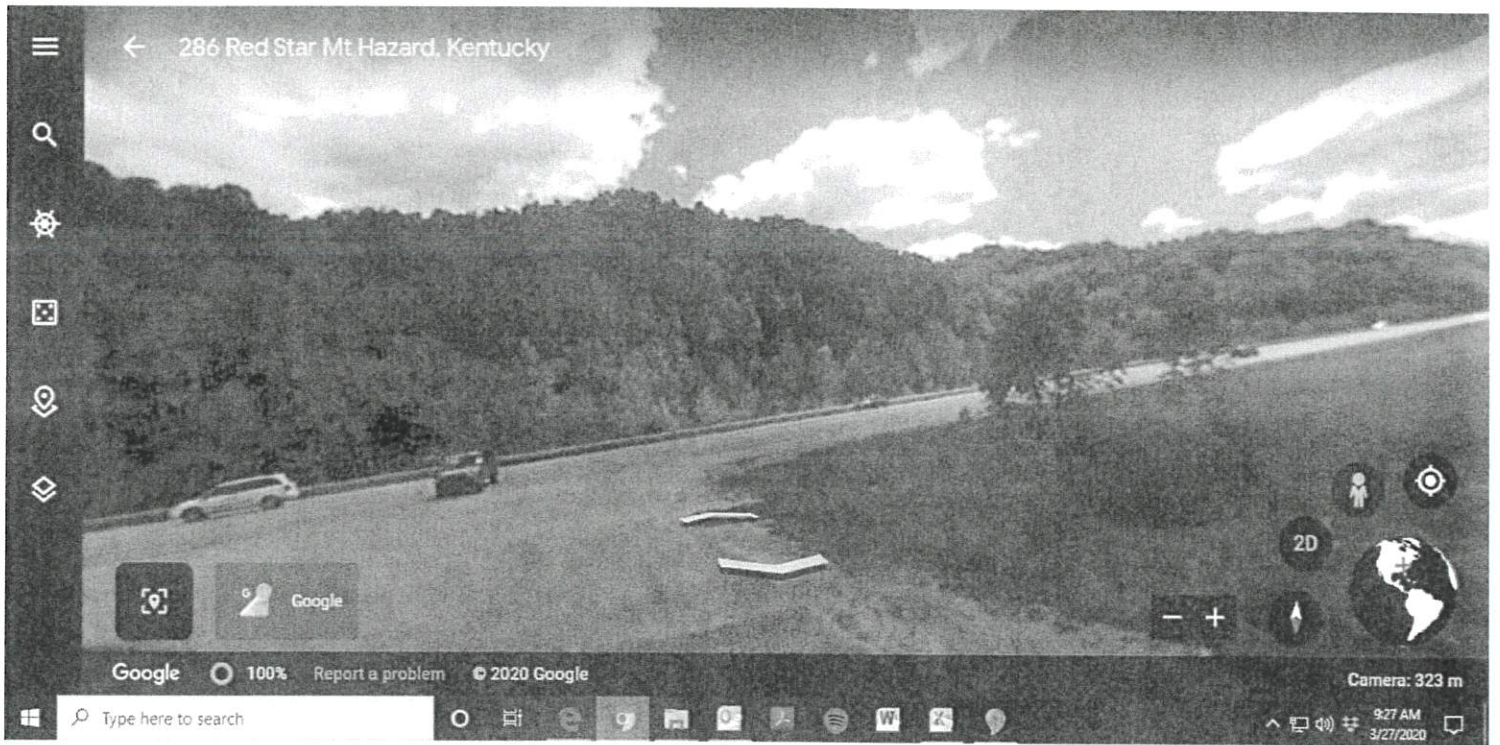

KV 80, South Site, New Pump Station - South View

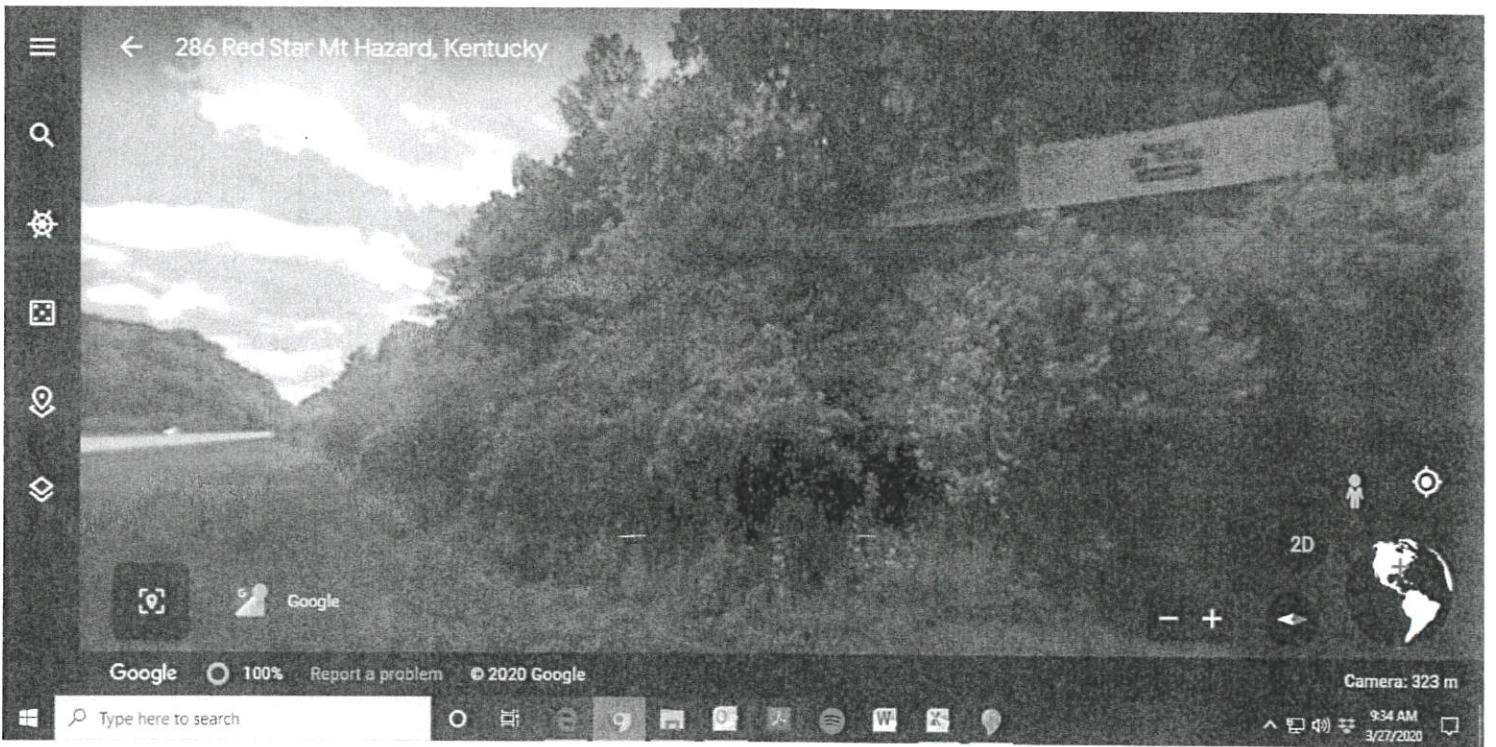

KY 80, South Site, New Pump Station - West View



KY 80 New Water Tank + Master Meter - Aerial View

GPS: Water Tank - $37^{\circ}21'22.931''N$
 $-83^{\circ}6'49.754''W$

Master Meter - $37^{\circ}21'22.227''N$
 $-83^{\circ}6'48.81''W$

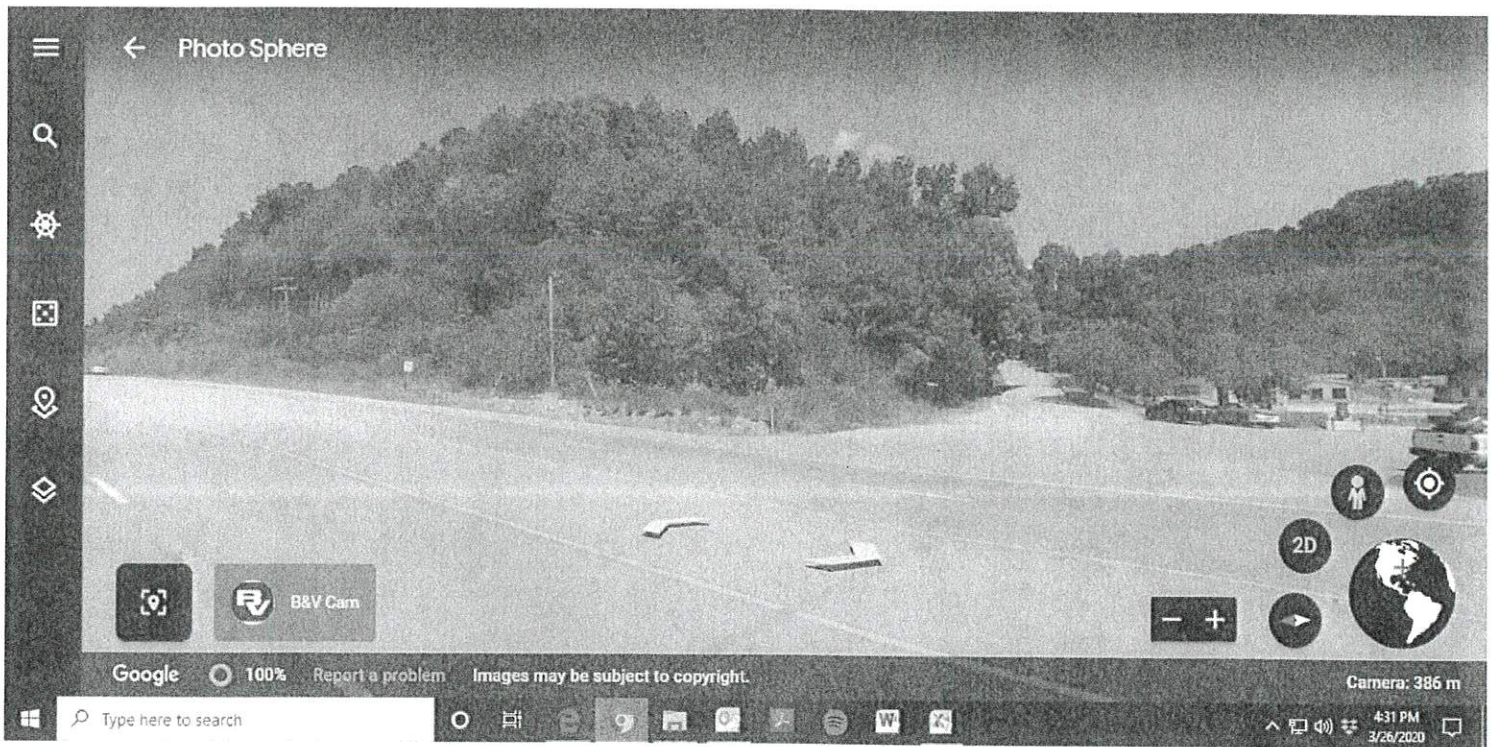

KY 80 New Water Tank & Master Meter - East View



KY 80 New Water Tank + Master Meter - North View



KY 80 New Water Tank + Master Meter - South View

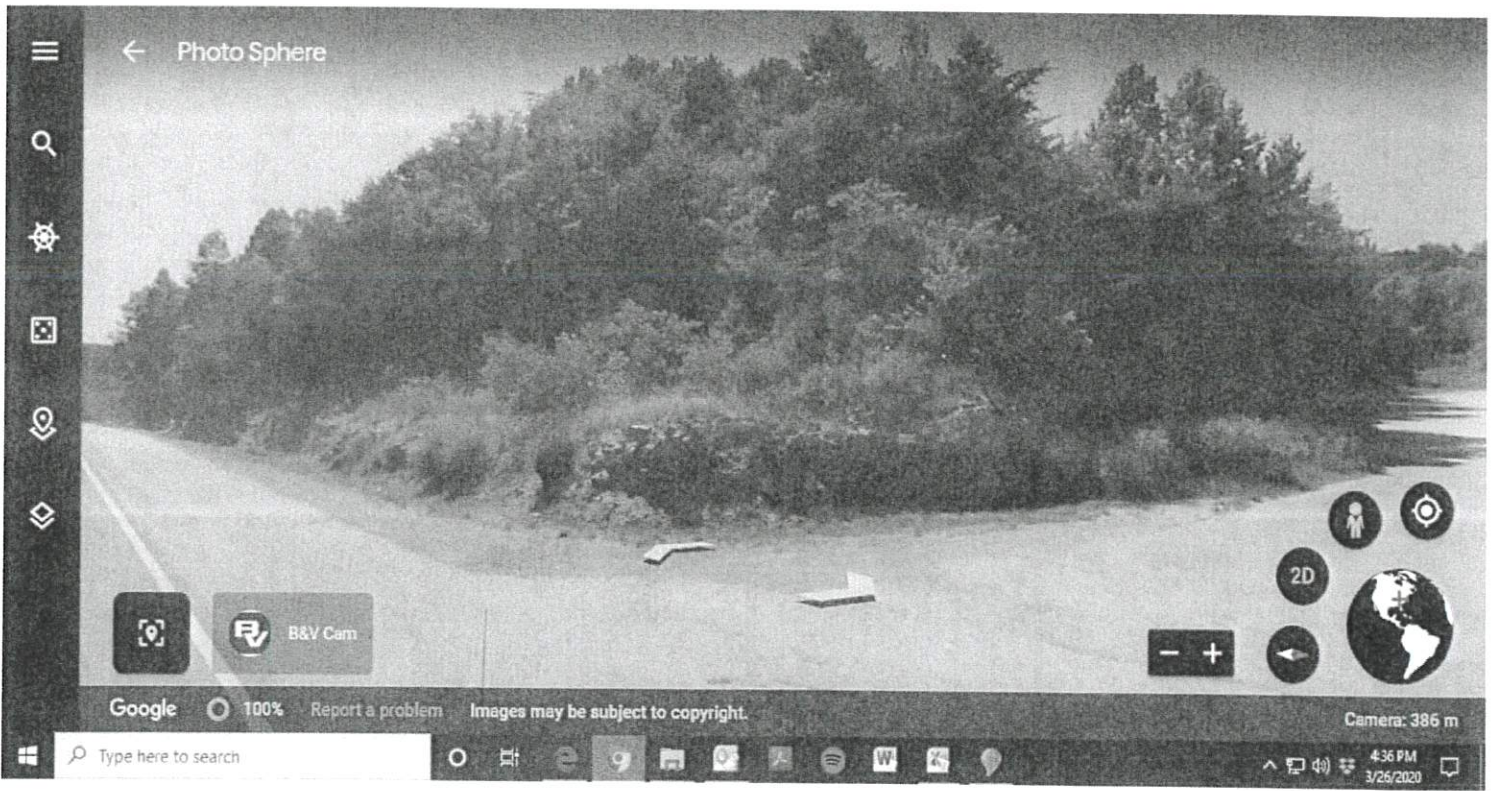

KY 80 New Water Tank + Master Meter - East View



KY 550 Master Meter - Aerial View

GPS: $37^{\circ}20'34.948''N$
 $-83^{\circ}6'57.35''W$



KY 550 Master Meter - East View

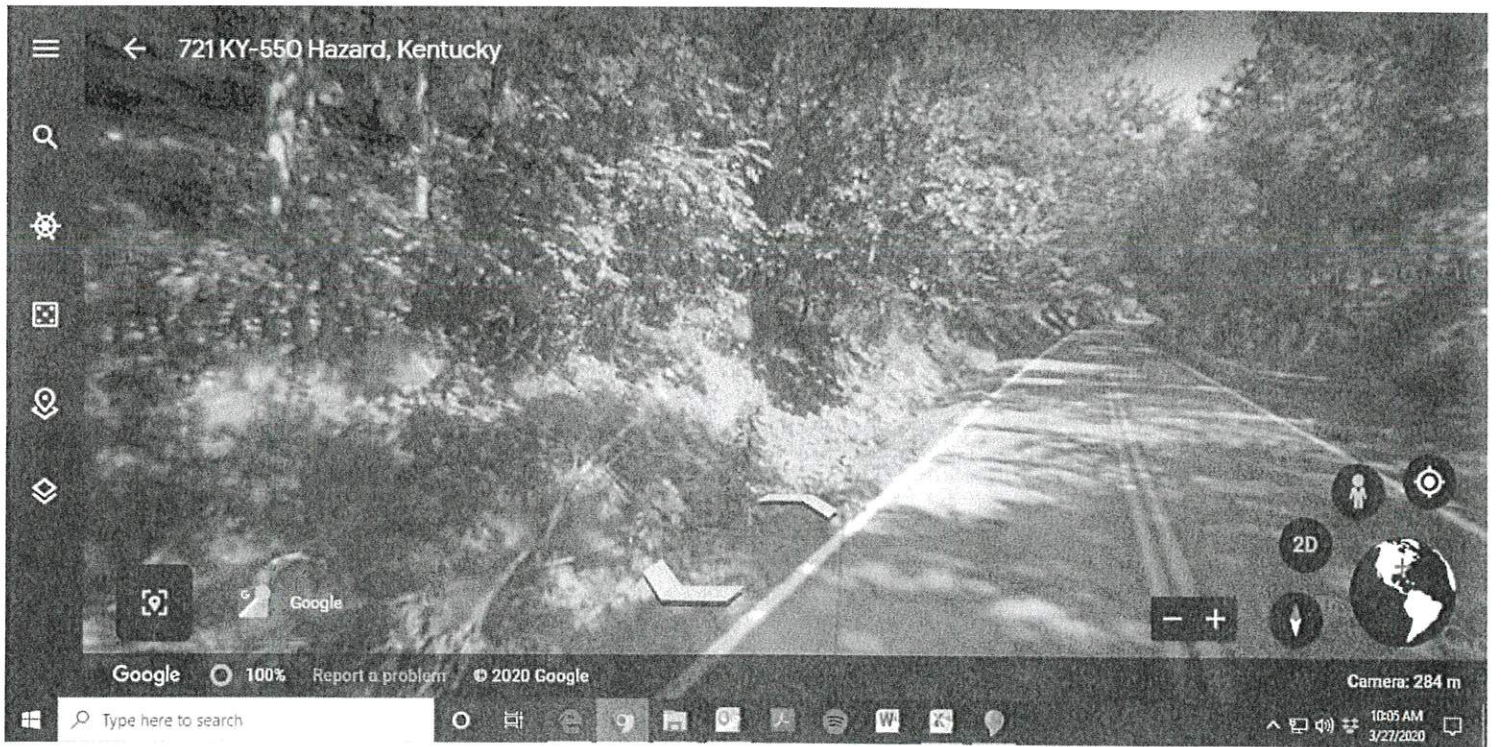

KY 550 Master Meter - North View



KY 550 Master Meter - South View